

# WESTPARK

BUSINESS PARK

8653 154TH AVE NE  
REDMOND, WA

## Building O // Suite 110/115

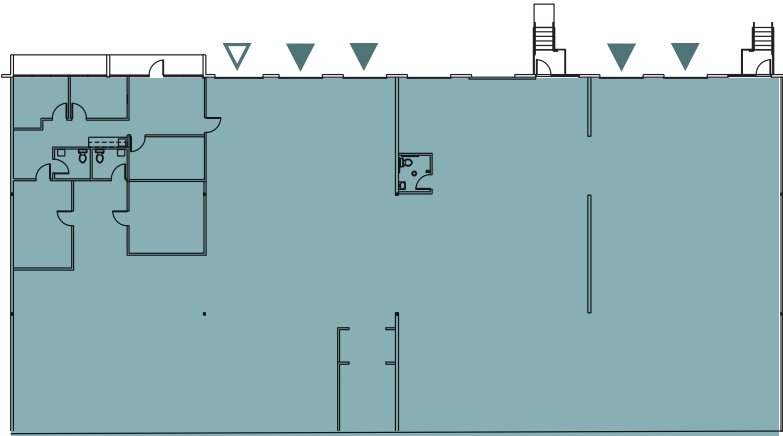

977 SF

AVAILABLE OFFICE

10,904 SF

AVAILABLE WAREHOUSE

11,881 SF

TOTAL AVAILABLE



△ GRADE LEVEL  
▲ DOCK HIGH

### FOR LEASING INFORMATION CONTACT

**MARK FLIPPO**

JLL  
425.974.4007  
mark.flippo@am.jll.com

**JASON BLOOM**

Kidder Mathews  
425.450.1102  
jason.bloom@kidder.com



PACIFIC OAK

WESTPARKREDMOND.COM

This information supplied herein is from sources we deem reliable. It is provided without any representation, warranty or guarantee, expressed or implied as to its accuracy. Prospective Buyer or Tenant should conduct an independent investigation and verification of all matters deemed to be material, including, but not limited to, statements of income and expenses. Consult your attorney, accountant, or other professional advisor.

